

INSTRUCTION SHEET (u)

1976-1979 Chevrolet Suburban middle 60/40 split bench Instruction Sheet



Dear Customer,

As we are unable to assist you on installing your Wet Okole Hi. Waterproof sport seat covers we offer these special instructions. This particular instruction is a universal instruction for Chevy Suburban. Mostly all other vehicles are self explanatory. Any problems please feel free to call for technical support at 1(888)24-Okole. Enjoy your Wet Okole Hawaii Seat Covers!

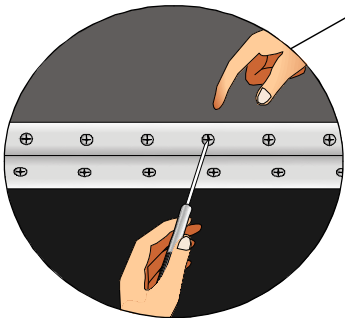

Remove phillips screws from behind the seat. Install seat covers and re-install screws. Small holes can be made on back of neoprene seat cover with a sharp nail or ice pick to install phillips screws

Back of backrest

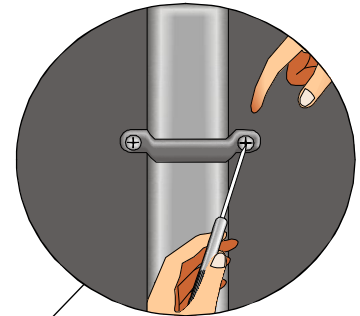

Note: On certain models there are metal seat belt brackets that are attached on the front of the lower backrest cushions with (2) Phillips screws remove screws prior to seat cover installation.

Front of backrest

INSTALLATION QUESTIONS

TECHNICAL ASSISTANT HOT-LINE CALL TOLL FREE 1(888) 24-OKOLE
MONDAY-SATURDAY 8:00 A.M.-4:30 P.M. PACIFIC TIME.